

Activate a different timer programme

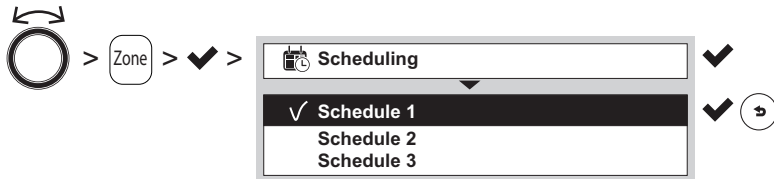

I have run out of hot water

Boost the production of domestic hot water for a few hours

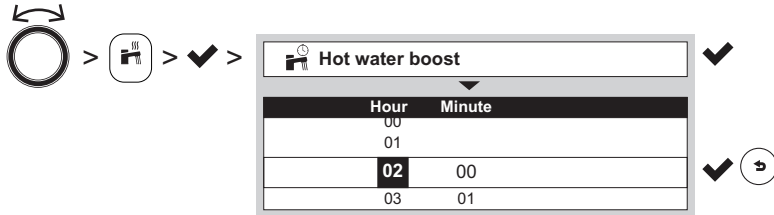

I am away for a few days

Reduce the room temperature and the domestic hot water temperature during this period of absence

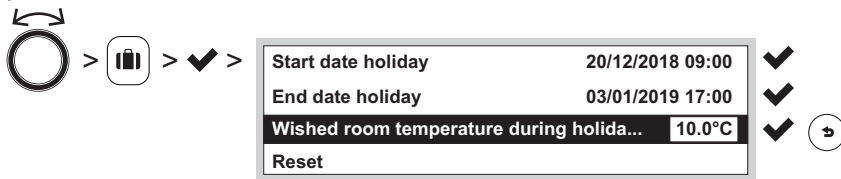

I want to stop the heating and activate cooling*

Activate Summer mode. Domestic hot water production is maintained.

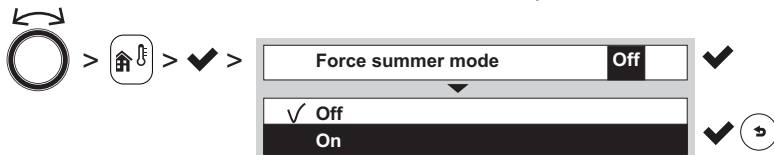

* only when a heat pump is used

Quick user guide

Standby screen

To deactivate the standby screen, press , or .

The screen goes into standby if no key is pressed for five minutes.

Description of the interface

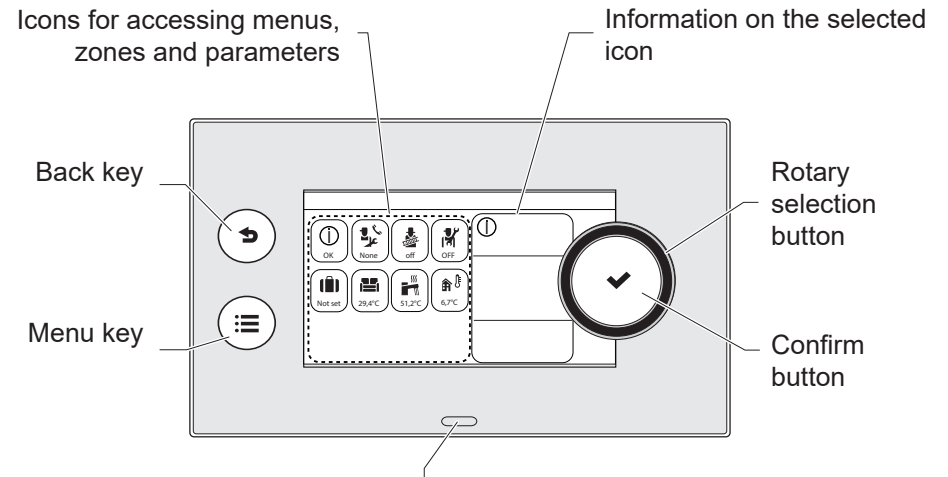

Status indicator LED

- continuous green = normal operation
- flashing green = warning
- continuous red = shutdown
- flashing red = lockout



Heating zones

In your installation, a heating zone is represented by one of the following icons:



Selected icon

Description of the selected icon

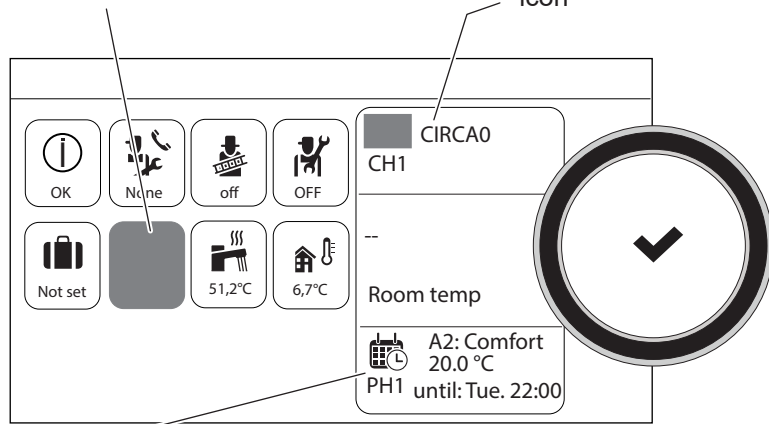

Operating mode active in the selected zone:



Timer programme

- PH1 = programme 1
- PH2 = programme 2
- PH3 = programme 3
- PH4 = cooling programme



Manual mode



Temporary override



Holiday mode



Frost protection mode

I am too hot or too cold

Alter the temperatures used in the timer programmes



> Zone > ✓ >

Set activity temperatures	
Reduced	16.0°C
Comfort	20.0°C
Away	6.0°C
Morning	21.0°C
Evening	22.0°C
▼	
19.0	
19.5	
20.0 °C	
20.5	

Alter the room temperature for a few hours



> Zone > ✓ >

Short temperature change	
Hour	Minute
01	
02	
03	00
04	01
▼	
19.0	
19.5	
20.0 °C	
20.5	

I have changed my routine

Alter the timer programme (for heating, domestic hot water or cooling)



> Zone > ✓ >

Zone configuration		
▼		
Heating Schedule		
▼		
Schedule 1		
Schedule 2		
Schedule 3		
▼		
Monday	Tuesday	Wednesday
6:00	Comfort	22.0°C
23:00	Reduced	19.0°C
Add time and Activity		
Copy to other day		
Set Activity Temperatures		
▼		
...		